

# Advanced Ceramics



West Chicago Community High School  
Ms. Dulkyns  
Spring 2021, Room 1142  
mdulkyns@d94.org  
(630) 876-6408

## Course Details

The Advanced Ceramics course allows an advanced ceramics student to **pursue independent projects under the guidance of the teacher**. We will all begin the semester with the creation of an Image Bank, and Sketch Journal and digital portfolio. Students will use these resources as a place to get inspired, sketch out ideas for projects and record the progress of your work through the semester.

All advanced students will be given broad topics to inspire their work and help focus their production. At the end of the semester, they will have a **body of sophisticated pieces that demonstrate their own artistic growth and skill**.

**Students will plan, design and produce original ceramic work.** Assessment will be done on work in progress, finished work and the entire body of work created in a semester.

Students will be given **reading and reflecting** assignments to deepen their understanding of, and connection to the world of ceramics.

**Participation** is an important part of this class and is made up of the following: promptness to class, preparedness, respect, Camera On (Virtual), positive interaction, and daily work. Since we are working with the expression of our own ideas and opinions, some of which can be very personal, having a positive community atmosphere in an art classroom is vitally important. Also, due to various safety and health concerns, it is very important to keep your work space clean.

## Course Objectives

Students will learn to...

Independently **conceptualize, organize, refine and complete** artistic ideas and work.

Synthesize and relate knowledge and personal experiences to **create artwork**.

**Develop and refine** artistic work for presentation, and **convey meaning** through the presentation of artistic work.

Perceive and analyze artistic work, interpret intent and meaning in artistic work, and **apply criteria to evaluate artistic work** – their own and that of others.

Relate artistic ideas and works with its context to **deepen understanding**.

**Refine proficiency** with the tools, techniques, and stages of clay.

## Supplies

Folder  
Pen/Pencil  
Chromebook

## Grade Determination

The standard grading scale is used. Student's grades are based upon

- The body of work you produce in this course (Construction and Glaze grades)
- Class work or Homework – Self-Reflections, Sketches, ArtTalks, etc.
- Final
- Participation (given every 2 weeks)

GRADING SCALE: 100 - 89.5 =A    89.4 - 79.5 =B    79.4 - 69.5 =C    69.4 - 59.5 =D    Below 59.4 =F

## Art Classroom Rules

**A** – Attitude (Artitude) Come in ready to work! ☺

**R** – Respect everyone and everything (Teacher, Classmates, Supplies, Art Work & Technology Rules)

**T** – Think about ART: Understand, Demonstrate & Reflect.

**I** – Imagine: Be CREATIVE & use your own ideas. \*

**S** – Safely use all materials.

**T** – Think throughout the creative process: Plan, Adjust, Reflect, Learn & Create More!

Electronic Devices or Phones are **not** to be used during class. Please silence them, put them away & engage with the people around you.

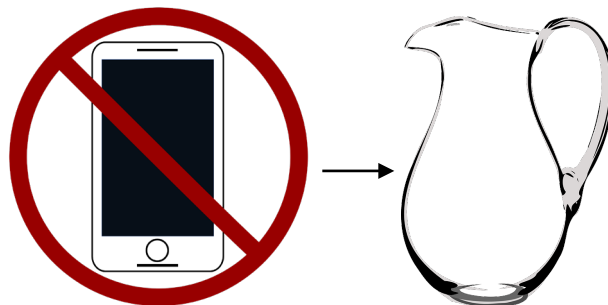

There is no throwing of clay, tools or materials. There is no food in the room and only drinks with a lid are allowed. This is for your health and safety.

\* As a general rule, if you cannot bring something to school or display it in school, it should not show up in your artwork unless you can prove, BEYOND DOUBT, that it serves expressive intent. I reserve the right to ask the deans to view anything that is questionable, to ask you to recreate anything that is questionable, and to not display anything that is questionable.

## Attendance

### TARDY

The school's tardy policy will be followed. You are tardy when the final bell has rung.

### ABSENT

**Excused** - You will have the opportunity to make up missed work or studio time. (E [1-6], V, O, ISS, OSS) **It is YOUR responsibility to see me about what you have missed!**

**Unexcused** - All work will be due on the original due date. Excused Absence Cap = 6/quarter. If you take more, you will not be allowed to make up the work.

## Ms. Dulkyns' Schedule

Class	Period	Room
Digital Photo 1	1	Zoom, 1134
Digital Photo 1	2	Zoom, 1134
Digital Photo 2	3	Zoom, 1134
Ceramics 1 & Advanced	7/8	Zoom, 1142
Ceramics 2 & Advanced	9	Zoom, 1142
Ceramics 2 & Advanced	10	Zoom, 1142

